

Acoustic Tube Assembly and Ear Insert Instructions

Applies to ESK-LIS25's, ESK-LIS35's, ESK-1WATD-XX, and ESK-2WPM-XX Surveillance Kits

1. Plug the two pin connector into the transducer (speaker).

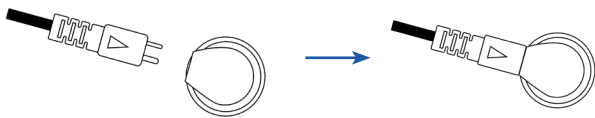

2. Snap and transducer into the transducer clip and slide the cord's strain relief into the strain relief bracket.

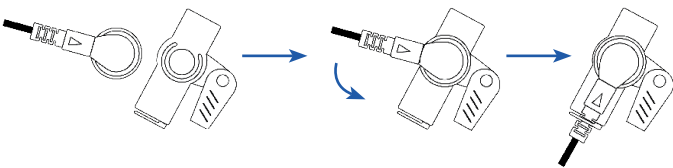

3. Slide the curved part of the tube onto the elbow.

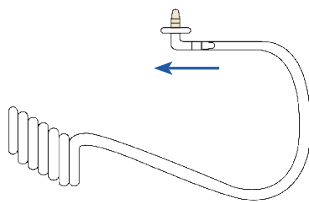

4. Slide the straight part of your tube onto the tube key.

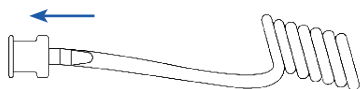

5. Insert the tube key into the tube key holder on the transducer clip and turn clockwise to lock in place.

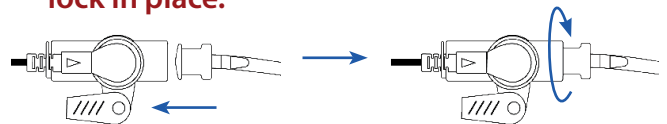

6. Attach the earbud or open ear insert into the elbow.

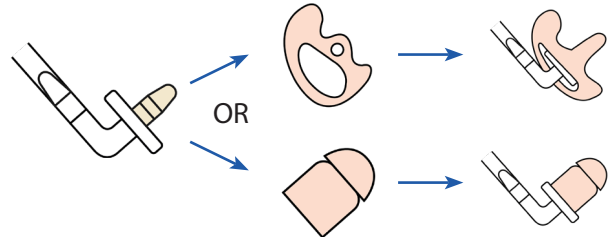

Wearing the Open Ear Insert

Before inserting the open ear insert check to see the size and side written on the earpiece. When inserting make sure the cone-shaped stem of the ear insert goes into the ear canal. The half "moon" shaped frame should rest towards the back of the ear. The large knob slides into the upper pocket of the ear.

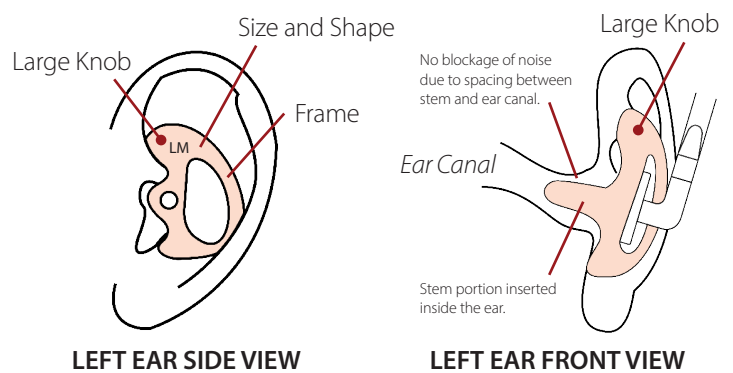

LEFT EAR SIDE VIEW

LEFT EAR FRONT VIEW

Toll Free 800-529-1618
Local 770-740-9400
Fax 770-569-1844
Web powerproducts.com

Serving the wireless industry since 1994.

Troubleshooting and maintaining your earpiece

Can't transmit or transmits but the receiver cannot hear anything?

1. Check to make sure the radio is on and functioning properly.
2. Check to make sure the receiver's radio is on and functioning properly.
3. Check to make sure the mic is attached to the radio correctly.
4. Check to make sure the PTT is pressed down all the way when transmitting.
5. If there is still no transmission after all the above steps,

Low audio or can't hear anything?

1. Check to make sure the radio is on and functioning properly.
2. Check to make sure the mic is attached to the radio correctly.
3. Check to make sure the acoustic tube has been assembled onto the unit correctly.
4. Check to see if the tube is clean and free of any debris that may block the sound from the transducer.
5. Check to see if there is sound coming from the transducer. If there is no sound coming from the transducer after the previous steps have been taken, replace the transducer.

How to clean your tube:

1. Disconnect and remove the tube from the transducer clip.
2. Check for wax and debris on the inside of the tube, elbow, and the tube key.

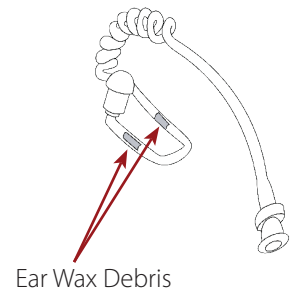
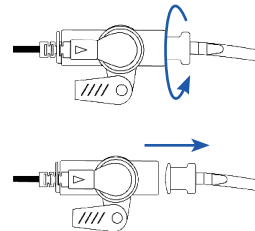

3. Completely submerge the tube along with the tube key and elbow into a cup of hot water to clean out the wax debris.
4. Using an air can, dry and blow out any additional debris and water from the tube.

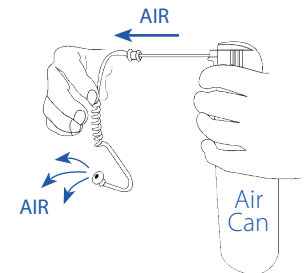
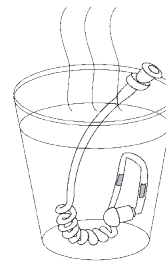

5. Wipe the tube down with a dry towel. Repeat procedure again if necessary.